

# Option - 3e

St Sophias New School/Area-  
net area 655 sqm 72sqm  
total 727 sqm  
gross area 695 sqm 87sqm  
total 750 sqm  
Internal Relub Area -150sqm  
Add Gym Extension -132 sqm

- GALSTON-15 TEACHING ROOMS + 3 SUPPLEMENTARY
- ST SOPHIAS-NEW BUILD 4 CLASSROOMS + 3 SUPPLEMENTARY
- SHARED

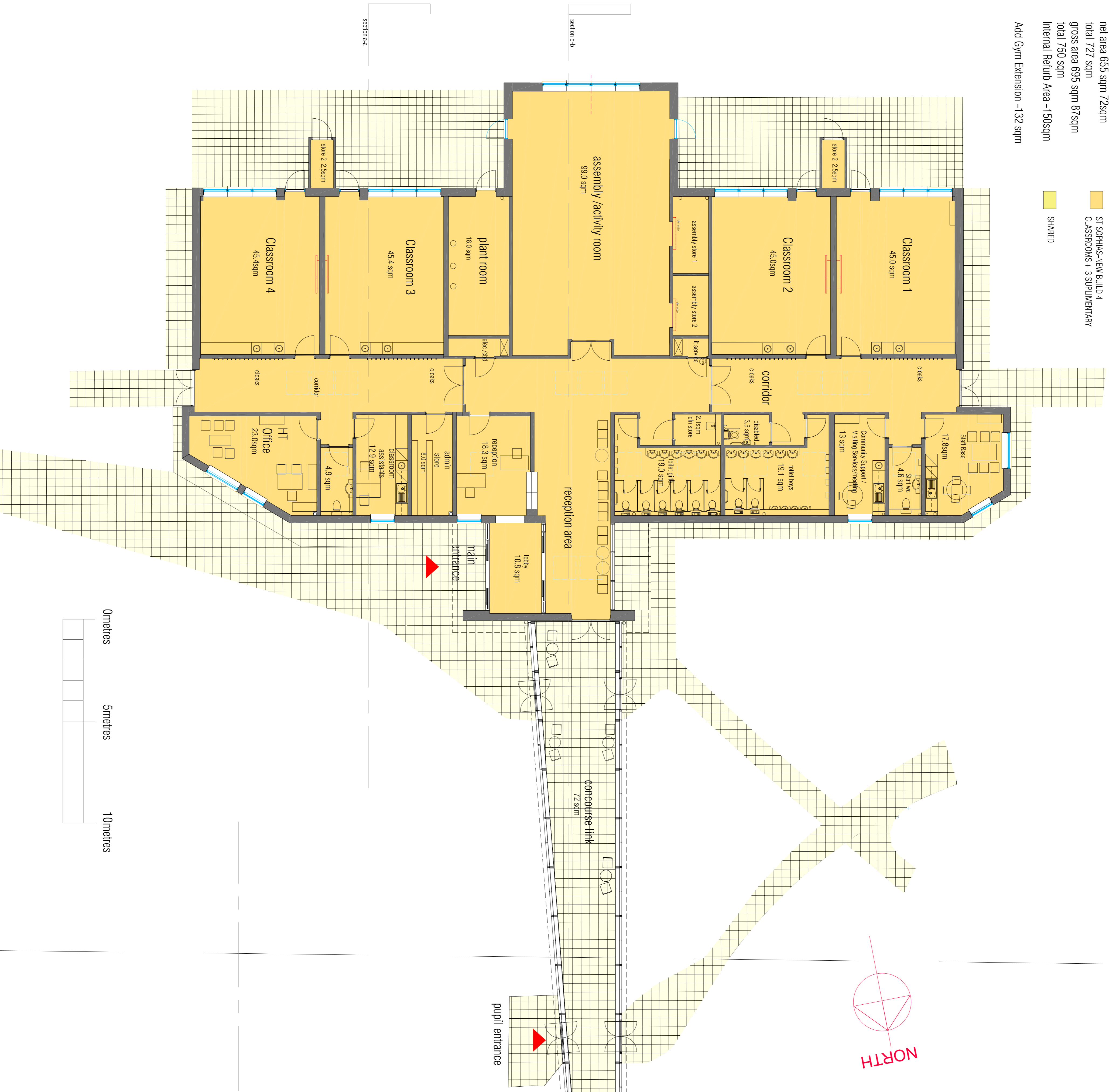

**WARNING:**  
This drawing must not be scaled, only where dimensions to be respected.  
Contractor must verify all necessary access & permissions on the prior to commencing work.  
**ELECTRICAL:**  
Electrical installations to comply with BS 7671: 2008 Amendment 3 (ETB) Wiring Regulations.  
All in addition to East Ayrshire Council's technical specifications.  
**CDM:**  
CDM 1 holders will be required to comply with the requirements of the current CDM Regulations, as they apply to them.  
Please note that CDM applies to all construction work and as such to the responsibility of all duty holders on other persons involved in the project.  
**NOTES:**  
No work to commence without an appropriate access survey being in place.  
Where the contractor is required to construct, supply, store and/or dispose of the materials, they must be stored in a secure manner and the Contractor who will conduct the appropriate person within the Council to arrange for suitable. Any subcontractor's work will be operated in East Ayrshire Council's specialist term contract.

**East Ayrshire COUNCIL**  
Safer Communities  
Facilities & Property Management  
Operational House  
8 John Finnie Street  
Kilmarnock  
KA1 1DD  
Project:  
St Sophias's co-location at Galston Primary School

Tel : 01563 55  
Fax : 01563 55233  
www.east-ayrshire.gov.uk

**EDUCATION AND SOCIAL SERVICES**  
Drawing Title  
PROPOSED GROUND FLOOR PLAN

Project File Ref: 15/191  
TF No. ES/RF  
Drawing Status: PLANNING  
Date: Nov 2015 11:00  
Scale: B  
Rev: A1

05/05/2016  
07/04/2016  
A: 05/05/2016  
B: 07/04/2016  
By: [Signature]  
Drawn By: [Signature]  
Checked By: [Signature]

